

DS-KH9310-WTE1(B)

Video Intercom Network Indoor Station

HIKVISION[®]

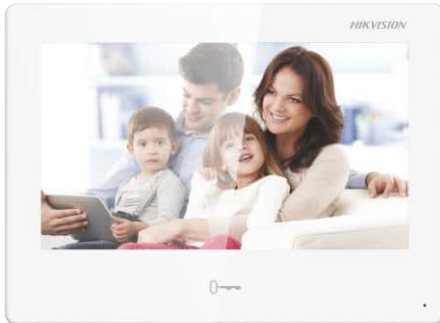

Key Feature

- 7-inch colorful touch screen with resolution 1024 × 600
- Supports Android app installation
- Open platform for the third-party software integration
- Video intercom & live view on mobile phone all-day
- Built-in Hik-Connect for all-in-one management
- Wireless intrusion panel for on-site management
- Receives 7 seconds of video verification from alarm systems

Physical Interface

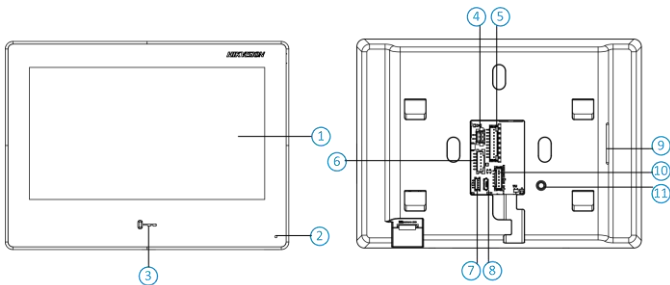

No.	Description	No.	Description
1	Screen	7	Debugging Port
2	Microphone	8	microUSB Interface
3	Unlock Button	9	Loudspeaker
4	Power Supply Interface	10	Reserved
5	Alarm Terminals	11	TAMPER
6	RS-485/Relay Interface	12	Network Interface

Specification

System parameters	
Operating system	Embedded Android operation system
ROM	8 GB Emmc
RAM	2 GB
CPU	Embedded processor
Display parameters	
Screen size	7-inch
Operation method	Capacitive touch screen
Type	Colorful TFT
Resolution	1024 × 600
Video parameters	
Lens	/
Resolution	/
FOV	/
WDR	/
Video compression standard	/
Focal length	/

Audio parameters	
Audio compression standard	G.711 U, G.711 A
Audio input	Built-in omnidirectional microphone
Audio output	Built-in loudspeaker
Audio compression bitrate	64 Kbps
Audio quality	Noise suppression and echo cancellation
Volume adjustment	Adjustable
Capacity	
Event capacity	200
Notice capacity	16
Linked indoor extensions capacity	5
Network parameters	
Communication protocol	TCP/IP, SIP, RTSP
Wired network	Support
Wi-Fi standard	Wi-Fi 802.11 b/g/n
Bluetooth version	/
3G/4G standard	/
Zigbee	/
Device interfaces	
Alarm input	8
Network interface	1 RJ-45 10/100 Mbps self-adaptive
TAMPER	/
RS-485	1
TF card	Reserved
Alarm output	1 relay output, 1 alarm output
Power interface	1
General	
Button	/
Installation	Surface mounting
Indicator	/
Weight	Without package: 419.3 g With package: 694 g
Protective level	/
Working temperature	-10 ° C to 50 ° C (14 ° F to 122 ° F)
Working humidity	10% to 90%

Dimensions	187 mm × 137 mm × 25.7 mm (7.36" × 5.39" × 1.01")
Battery	/
Power supply	IEEE802.3af, standard PoE 12 VDC, 1 A
Application environment	Indoor
Power consumption	≤ 8 W
Language	English, French, Portuguese (Brazil), Spanish, Russian, German, Italian, Polish, Arabic, Turkish, Vietnamese, Hungarian, Dutch, Romanian, Czech, Bulgarian, Ukrainian, Croatian, Serbian, Greek, Norwegian, Danish

Available Model

DS-KH9310-WTE1(B)

Dimension

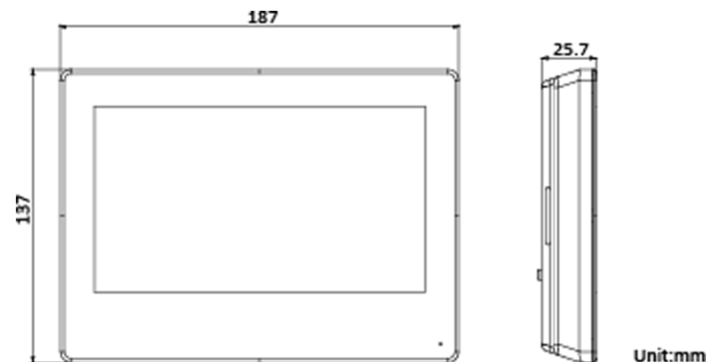

Headquarters

No.555 Qianmo Road, Binjiang District,
Hangzhou 310051, China
T +86-571-8807-5998
www.hikvision.com



Follow us on social media to get the latest product and solution information.

