

# DS-2CD2022-I (2.0MP)

# DS-2CD2032-I (3.0MP)

## IR Mini Bullet Network Camera

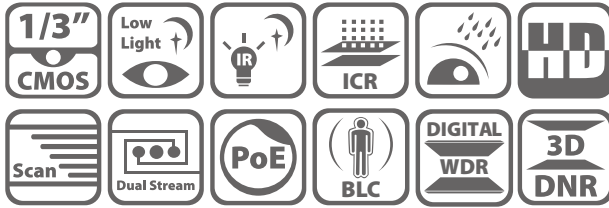

### Key features

- 2MP / 3MP high resolution
- HD real-time video
- 3D DNR & DWDR & BLC
- IR LEDs: up to 30m
- IP66
- PoE
- Compact design
- Bracket included

### Dimensions

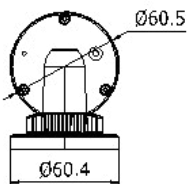
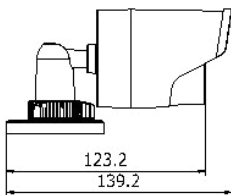
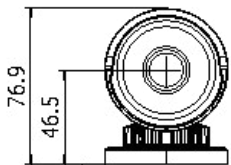

Unit: mm

### Available models

DS-2CD2022-I (2.0MP)

DS-2CD2032-I (3.0MP)

\* 1.3MP model is also available -- DS-2CD2012-I



www.use-ip.co.uk  
01304 827609

	DS-2CD2022-I	DS-2CD2032-I
<b>Camera</b>		
Image sensor	1/3" progressive scan CMOS	
Min. illumination	0.01 lux @F1.2, AGC ON, 0 lux with IR	0.07 lux @F1.2, AGC ON, 0 lux with IR
Shutter time	1/3s ~ 1/100,100s	
Lens	4mm @ F2.0 (6mm optional) Angle of view: 79°(4mm), 49°(6mm)	4mm @ F2.0 (6mm optional) 1920 × 1080: Angle of view: 12mm 79°(4mm), 49°(6mm) Angle of view: 25° 2048 × 1536: Angle of view: 70°(4mm), 43.3°(6mm)
Lens mount	M12	
Day & night	ICR	
Digital noise reduction	3D DNR	
Wide dynamic range	Digital WDR	
<b>Compression Standard</b>		
Video compression	H.264 / MJPEG	
H.264 codec profile	Main profile	
Bit rate	32 Kbps ~ 16 Mbps	
Dual stream	Yes	
<b>Image</b>		
Max. Image Resolution	1920 × 1080	2048 × 1536
Frame rate	50Hz: 25fps (1920 × 1080), 25fps (1280 × 720) 60Hz: 30fps (1920 × 1080), 30fps (1280 × 720)	50Hz: 20fps (2048 × 1536), 25fps (1920 × 1080), 25fps (1280 × 720) 60Hz: 20fps (2048 × 1536), 30fps (1920 × 1080), 30fps (1280 × 720)
Image settings	Saturation, brightness, sharpness, contrast, sharpness adjustable through client software or web browser	
BLC	Yes, zone configurable	
<b>Network</b>		
Network storage	NAS	
Alarm trigger	Motion detection, line crossing detection, tampering alarm, scene change detection, face detection, intrusion detection	
Protocols	TCP/IP, ICMP, HTTP, HTTPS, FTP, DHCP, DNS, DDNS, RTP, RTSP, RTCP, PPPoE, NTP, UPnP, SMTP, SNMP, IGMP, 802.1X, QoS, IPv6, Bonjour	
System compatibility	ONVIF, PSIA, CGI	
General functionalities	User Authentication, watermark, reset button	
<b>Interface</b>		
Communication interface	1 RJ45 10 M / 100 M Ethernet interface	
<b>General</b>		
Operating conditions	-30 °C ~ 60 °C (-22°F ~ 140 °F) humidity 95% or less (non-condensing)	
Power supply	12 VDC ± 10% , PoE (802.3af)	
Power consumption	Max. 5W (max. 7W with ICR on)	
Weather proof rating	IP66	
IR range	Up to 30m	
Dimension	60.4 x 76.9 x 139.2mm	
Weight	500g	