

### INTRODUCTION

Model	Description
AP-GIC-011A-060	60W high power PoE output
AP-GIC-011A-095	95W high power PoE output (The PoE output should only be connected to an IP camera. It should not be connected to non-PoE devices, such as a PC's LAN port)

### PACKAGE CONTENTS

* 1x PoE injector	* 1x AC power cord
* 1x Quick Installation Guide	

### ⚠ IMPORTANT:

1. Use CAT5 or 5e UTP/STP cables.
2. AC input (100~240V/AC, 50~60Hz), for a max. consumption of 65/100W.

### CONNECTION

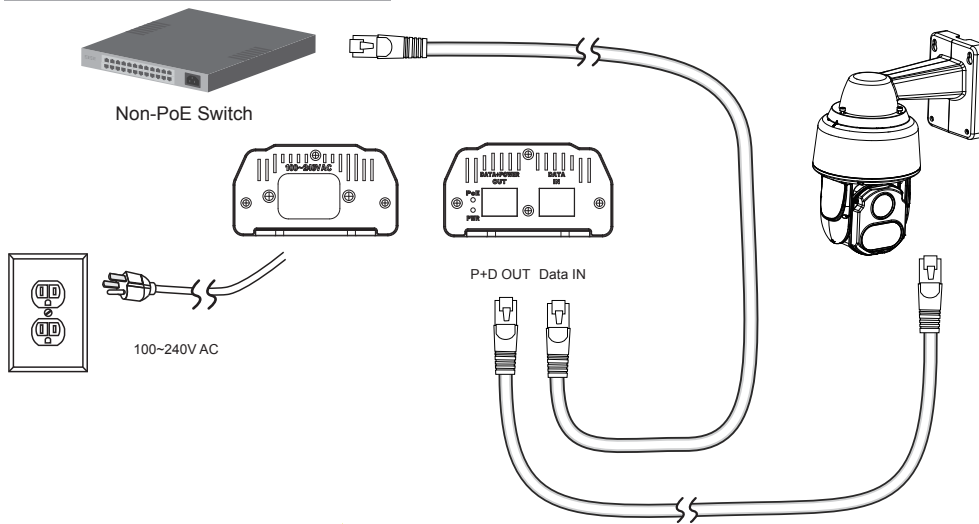

### Installation Steps:

1. Connect the included AC power cord to the injector. The Power LED (Green) should be lit.
2. Connect the Data IN port to a LAN switch using an Ethernet cable.
3. Connect the Power+Data OUT port to a powered device, i.e., IP camera, using another Ethernet cable. Make sure the PoE LED (Yellow) is lit.
4. Check if the powered device (IP camera) is working properly. An IP camera may take up to 1 or 2 minutes to power up.