



Weatherproof Connection For Network Devices



- Protected connection point, e.g. for an IP camera
- Complete set including assembly parts

Universal network connector for installation cables, MOBOTIX patch cables and standard patch cables

Connection Option A: Weatherproof Connection Patch Cable To Installation Cable (e.g. Cat. 7)

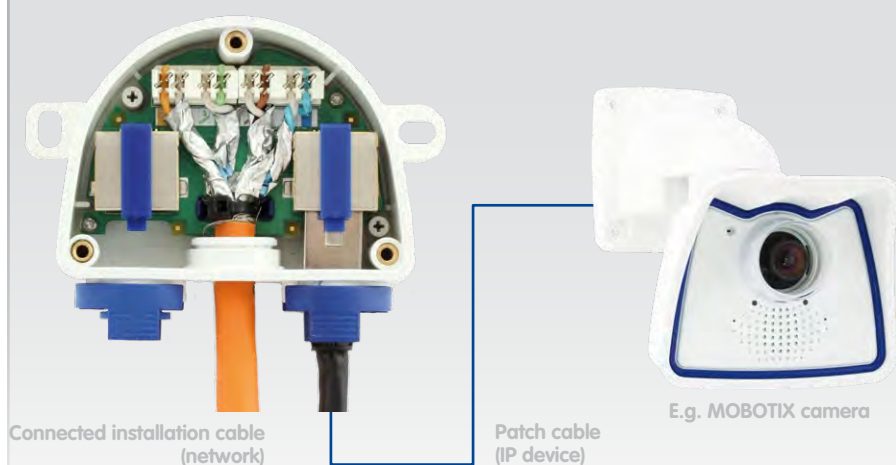

Assembly Instructions

1. Mount the box and insert the cable tie

Attach the MX-Patch-Box on the wall with the cable ports pointing down. Remove the box cover (three screws) and feed the supplied cable tie through the two slots in the circuit board.



2. Prepare the installation cable

Shorten the installation cable as required and push it through the white sealing plug 5-7 mm. Strip the outer jacket for at least 35 mm and separate the twisted pairs with 20 mm pair shield remaining. Wrap the braided shield around the jacket in a width of 10 mm so that it can rest on the contact surface of the circuit board later on.

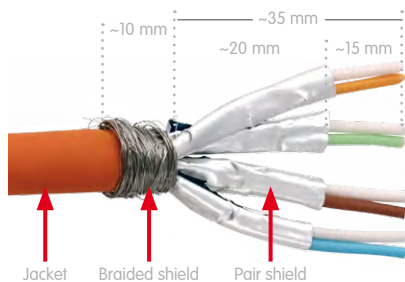

3. Affix the installation cable

Remove the plug in the center and insert the installation cable with the sealing plug 5-7 mm into the box. To prevent humidity from entering the box, the rubber sleeve of the plug needs to be tight around the cable. Pull the cable tie tightly around the cable shield to firmly attach the cable to the box.

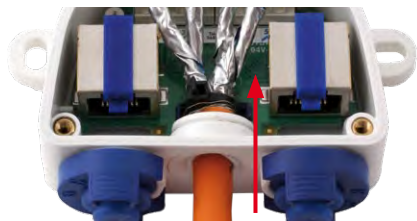

4. Connect the cable wires

Connect the individual wires of the installation cable to the LSA terminal using the appropriate LSA tool. When doing so, follow the EIA/TIA-568A or B connection scheme (see color code sticker in front of the LSA terminal). When using EIA/TIA-568A, swap the wires on the LSA terminal as follows: terminal 1 against terminal 3 and terminal 2 against terminal 6. Screw the cover back onto the box (torque 0.4 Nm).

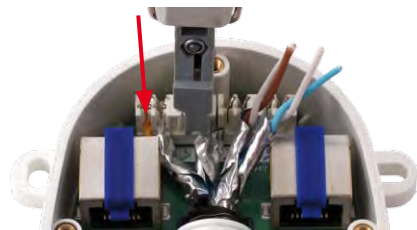

5. Attach the patch cable

Insert a MOBOTIX patch cable into either the left or right port and secure it using the bayonet catch (remove sealing plug first). A MOBOTIX sealing system for standard patch cables will be available soon.

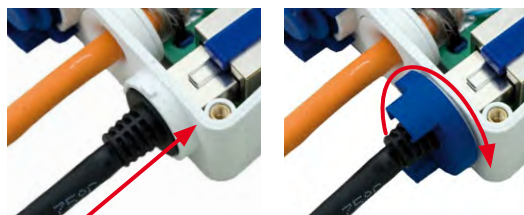

HiRes Video Innovations

The German company MOBOTIX AG is known as the leading pioneer in network camera technology and its decentralized concept has made high-resolution video systems cost efficient.

MOBOTIX AG • 67722 Langmeil, Germany • Tel.: +49-6302-9816-103 • Fax: +49-6302-9816-190 • sales@mobotix.com

Connection Option B: Weatherproof Connection Patch Cable To Patch Cable

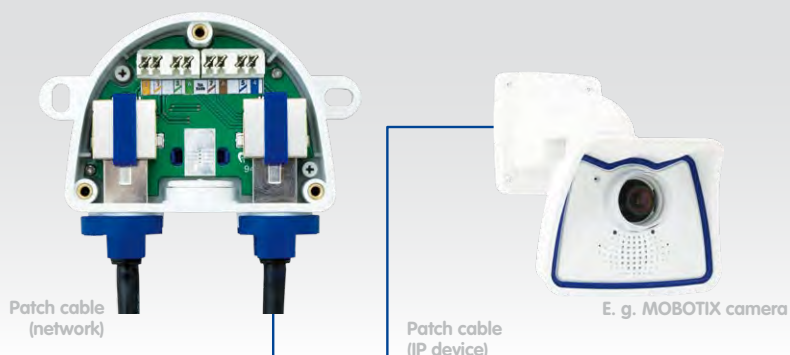

The patch cables with integrated washers (available from MOBOTIX in different lengths) are simply inserted into the RJ45 connectors and fastened using the bayonet catch (1x patch cable to end device, 1x patch cable to PoE switch/injector). It is not necessary to open the box.

Notes

- Position of the drilling holes when using a M24 Wall Mount: see drilling template below
- Maximum torque for all box cover screws: 0.4 Nm
- Only one end device (e.g. MOBOTIX camera) can be connected to the PatchBox
- All unused ports must be closed with the supplied rubber seals
- Pay attention to the correct twisting and shielding of the installation cable
- For measuring see EN 50173-1 Class D STP Chan (FastEthernet, frequency range 1 to 100 Mhz)

If the technical guidelines and information stated herein are not followed exactly, the manufacturer cannot be held liable under the German Product Liability Act.

Using Standard Patch Cables

Currently you can only use original MOBOTIX patch cables to connect to the RJ45 connectors. Standard cables purchased from other suppliers do not meet the necessary specifications for proper fastening and sealing (no longer weatherproof according to IP65).

MOBOTIX will be offering a sealing system for standard **RJ45 patch cables** in the near future.



Drilling Template for New M24 Wall Mount with MX-Patch-Box

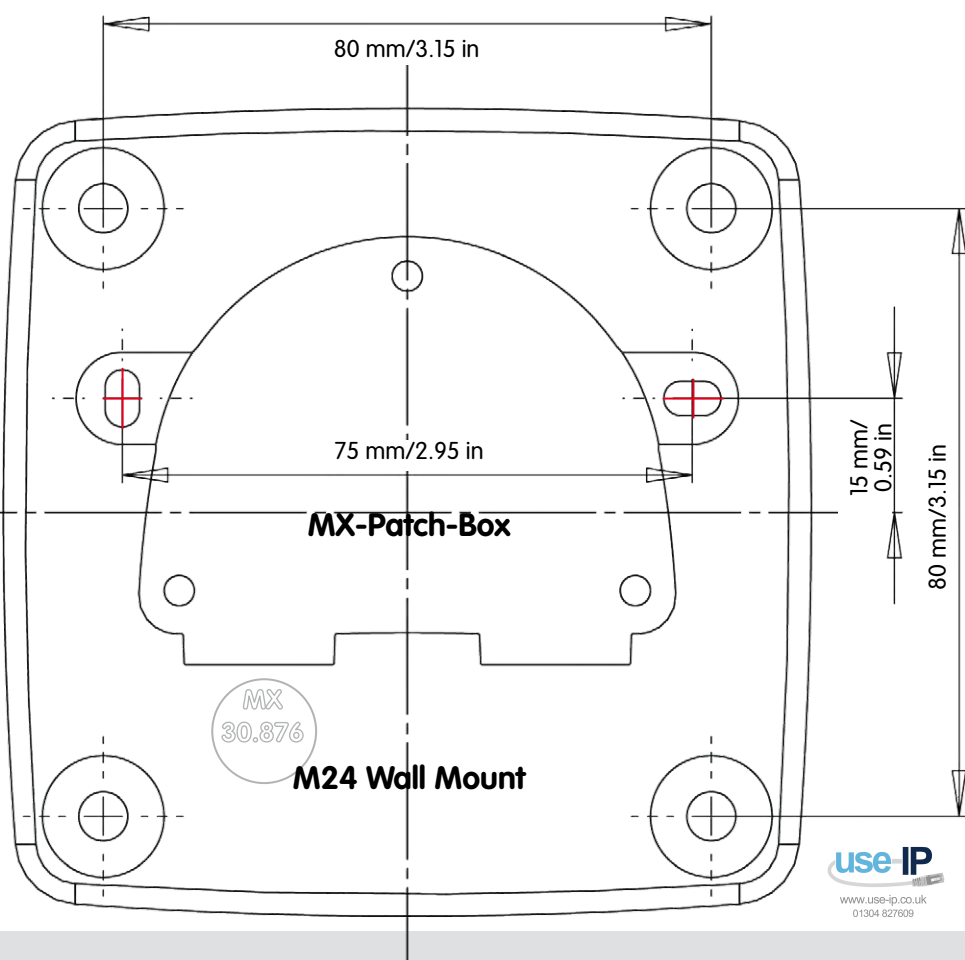

use IP
www.use-ip.co.uk
01304 827609

HiRes Video Innovations

The German company MOBOTIX AG is known as the leading pioneer in network camera technology and its decentralized concept has made high-resolution video systems cost efficient.

MOBOTIX AG • 67722 Langmeil, Germany • Tel.: +49-6302-9816-103 • Fax: +49-6302-9816-190 • sales@mobotix.com